

	8:00 a.m.	8:20 a.m.	8:30 a.m.	8:45 a.m.	10:00 a.m.	10:15 a.m.	10:30 a.m.	12:00 p.m.	1:15 p.m.	3:00 p.m.	3:15 p.m.	5:00 p.m.	
Monday August 26, 2019	Morning Plenary Session	Networking	Morning Training Courses					Lunch on Your Own	Afternoon Training Courses				
			<ul style="list-style-type: none"> EPA-lead Remedial Design/Remedial Action (RD/RA): Key Project Management Considerations Mining Sites: Reducing Site Investigation, Remediation and Operation and Maintenance Costs NEW Stand and Deliver Effective Presentations NEW Superfund Site Data Management 						<ul style="list-style-type: none"> Adaptive Management: Overview and Superfund Task Force Pilot Case Studies Focus on Geology for Improved Remediation Decision-Making Successfully Managing a Superfund Site NEW Individual Platform Performance Coaching Sessions (8, 50-minute sessions) NEW 				
									<ul style="list-style-type: none"> Forum Business Meeting Federal Facilities Forum Business Session 				
Tuesday August 27, 2019	Welcome and Opening Plenary Session			Networking	All-Hands Session			Lunch on Your Own	Afternoon Training Courses				
	Welcome and Opening Remarks				Reuse and Redevelopment All-Hands Session				<ul style="list-style-type: none"> Federal Facilities: Use of Decision Documents and Resolving Disagreements Before Formal Dispute NEW Implementing RAF for a Long-Term Response Action NEW COR EPA Only Risk Communication Strategies NEW Vapor Intrusion: Practical Applications 				
Wednesday August 28, 2019	Morning Plenary Session	Networking	Quarter-day Training Courses			Break 10:00 a.m. to 10:30 a.m.	Quarter-day Training Courses			Lunch on Your Own	Afternoon Training Courses		
			<ul style="list-style-type: none"> Federal Facilities Update EPA Only Implementing RAF during the RI/FS NEW COR EPA Only Implementing, Enforcing and Monitoring ICs Lost in Transition NEW Using Engineering Controls to Solve Complex Environmental Challenges – An Introduction to the Engineering Forum NEW 				<ul style="list-style-type: none"> Enforcement Focus: Settlement Tools for RPMs COR Implementing RAF as a Part of Project Management NEW COR EPA Only MNA in Remedial Action Decisions: Focus on the Groundwater Completion Strategy Personal Liability for RPMs 101 NEW EPA Only Sunsetting Your Site: NPL Deletions NEW 				<ul style="list-style-type: none"> Building Resilient Superfund Remedies DNAPL/LNAPL Source Zone Treatment, Path to Closure Module #1 - NAPL Primer, Policy/ROD, Challenges with Characterization Fine-Tuning Your Spokesperson Skills 1 Remedy Success: Getting the Community Involved 		
											<ul style="list-style-type: none"> Forum Business Meeting Contaminated Sediments Forum Business Session 		
Thursday August 29, 2019	Morning Plenary Session	Networking	Full-Day Training Course			Be Prepared: Know What to Say and How to Say It			Lunch on Your Own	Full-Day Training Course (continued)			
			<ul style="list-style-type: none"> Public Risk Perception and Risk Communication Raising the Bar for the FYR NEW Remedial Action Execution under EPA RAF Contracts: On-site Management Considerations COR EPA Only Working with Tribes during Superfund Responses 							<ul style="list-style-type: none"> Be Prepared: Know What to Say and How to Say It 			
			Morning Training Courses							Afternoon Training Courses			
			<ul style="list-style-type: none"> Public Risk Perception and Risk Communication Raising the Bar for the FYR NEW Remedial Action Execution under EPA RAF Contracts: On-site Management Considerations COR EPA Only Working with Tribes during Superfund Responses 							<ul style="list-style-type: none"> DNAPL/LNAPL Source Zone Treatment, Path to Closure Module #2 - RA Implementation and Plume Management Strategies Enforcement / Negotiations COR 3500.1 Remedial Caps and Reuse: Put it on the Cap RPM Case Studies 			
Friday August 30, 2019	Morning Plenary Session	Networking	Morning Training Courses										
			<ul style="list-style-type: none"> Air Monitoring for RPMs Fine-Tuning Your Spokesperson Skills 1 Incremental Sampling Basics The World of Per- and Polyfluoroalkyl Substances (PFAS) 										

Break
10:00 a.m. to 10:15 a.m.

Break
3:00 p.m. to 3:15 p.m.

Objectives of the NARPM Training Program

- ❖ Enable RPMs to maintain and develop the knowledge and skills essential to their successful job performance
- ❖ Provide a diverse learning experience that RPMs can attend in a single week at a single location
- ❖ Achieve inter-regional networking among RPMs as well as increase the effectiveness and efficiency through cross-regional communication
- ❖ Showcase regional case studies, current tools and resources available to RPMs
- ❖ Provide training opportunities for other remedial support personnel and tribal and state counterparts to interact with RPMs, and to learn and understand their roles and responsibilities during Superfund responses
- ❖ Ensure consistent training for a national Superfund program

Other Activities

Sunday, August 25, 2019

Onsite NARPM Check-in, Salons Foyer, 2:00 p.m. to 6:00 p.m.
Speaker Ready Room, Salon 7, 2:00 p.m. to 6:00 p.m.

Monday, August 26, 2019

Onsite NARPM Check-in, Salons Foyer, 7:00 a.m. to 5:30 p.m.
Speaker Ready Room, Salon 7, 8:00 a.m. to 6:00 p.m.
Morning Plenary Session, Empire Room, 8:00 a.m. to 8:20 a.m.
Mid-Morning Break, 10:00 a.m. to 10:15 a.m.
Afternoon Break, 3:00 p.m. to 3:15 p.m.
Resource Area, Salon Foyer

Tuesday, August 27, 2019

Onsite NARPM Check-in, Salons Foyer, 7:00 a.m. to 5:30 p.m.
Speaker Ready Room, Salon 7, 8:00 a.m. to 6:00 p.m.
Welcome and Opening Plenary Session, Empire Room, 8:00 a.m. to 10:00 a.m.
Mid-Morning Break, 10:00 a.m. to 10:15 a.m.
Afternoon Break, 3:00 p.m. to 3:15 p.m.
Resource Area, Salon Foyer

Wednesday, August 28, 2019

Onsite NARPM Check-in, Salons Foyer, 7:00 a.m. to 5:30 p.m.
Speaker Ready Room, Salon 7, 8:00 a.m. to 6:00 p.m.
Morning Plenary Session, Empire Room, 8:00 a.m. to 8:20 a.m.
Mid-Morning Break, 10:00 a.m. to 10:30 a.m.
Afternoon Break, 3:00 p.m. to 3:15 p.m.
Resource Area, Salon Foyer

Thursday, August 29, 2019

Onsite NARPM Check-in, Salons Foyer, 7:00 a.m. to 5:30 p.m.
Speaker Ready Room, Salon 7, 8:00 a.m. to 6:00 p.m.
Morning Plenary Session, Empire Room, 8:00 a.m. to 8:20 a.m.
Mid-Morning Break, 10:00 a.m. to 10:15 a.m.
Afternoon Break, 3:00 p.m. to 3:15 p.m.
Resource Area, Salon Foyer

Friday, August 30, 2019

Onsite NARPM Check-in, Salons Foyer, 7:00 a.m. to 9:00 a.m.
Morning Plenary Session, Empire Room, 8:00 a.m. to 8:20 a.m.
Mid-Morning Break, 10:00 a.m. to 10:15 a.m.

Floor Plans

Empire Room

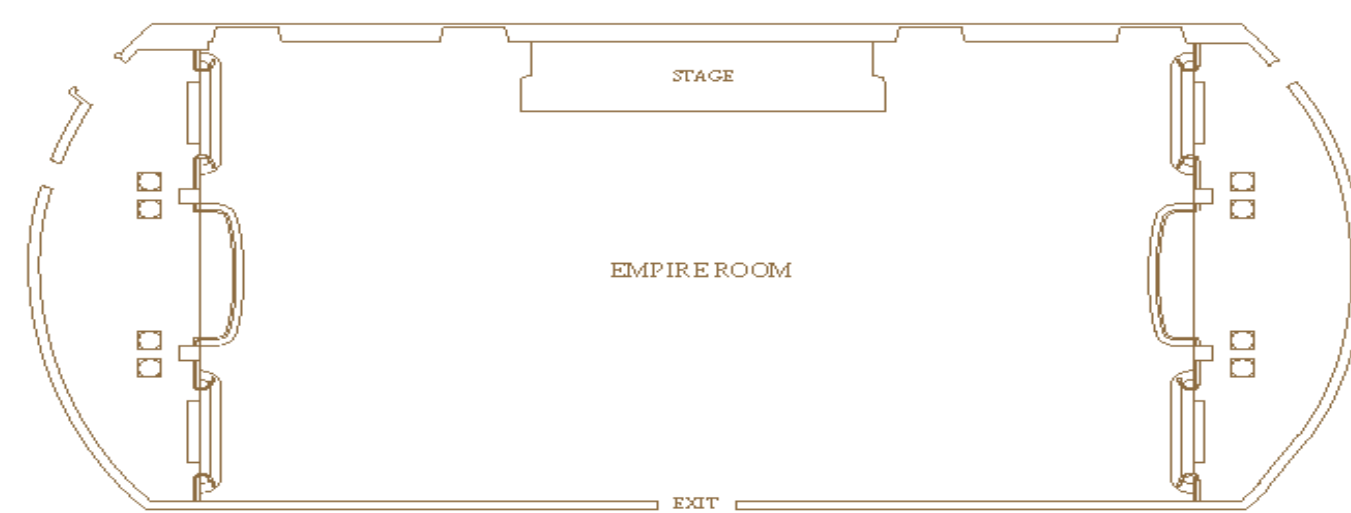

Third Floor Training Rooms and Salons

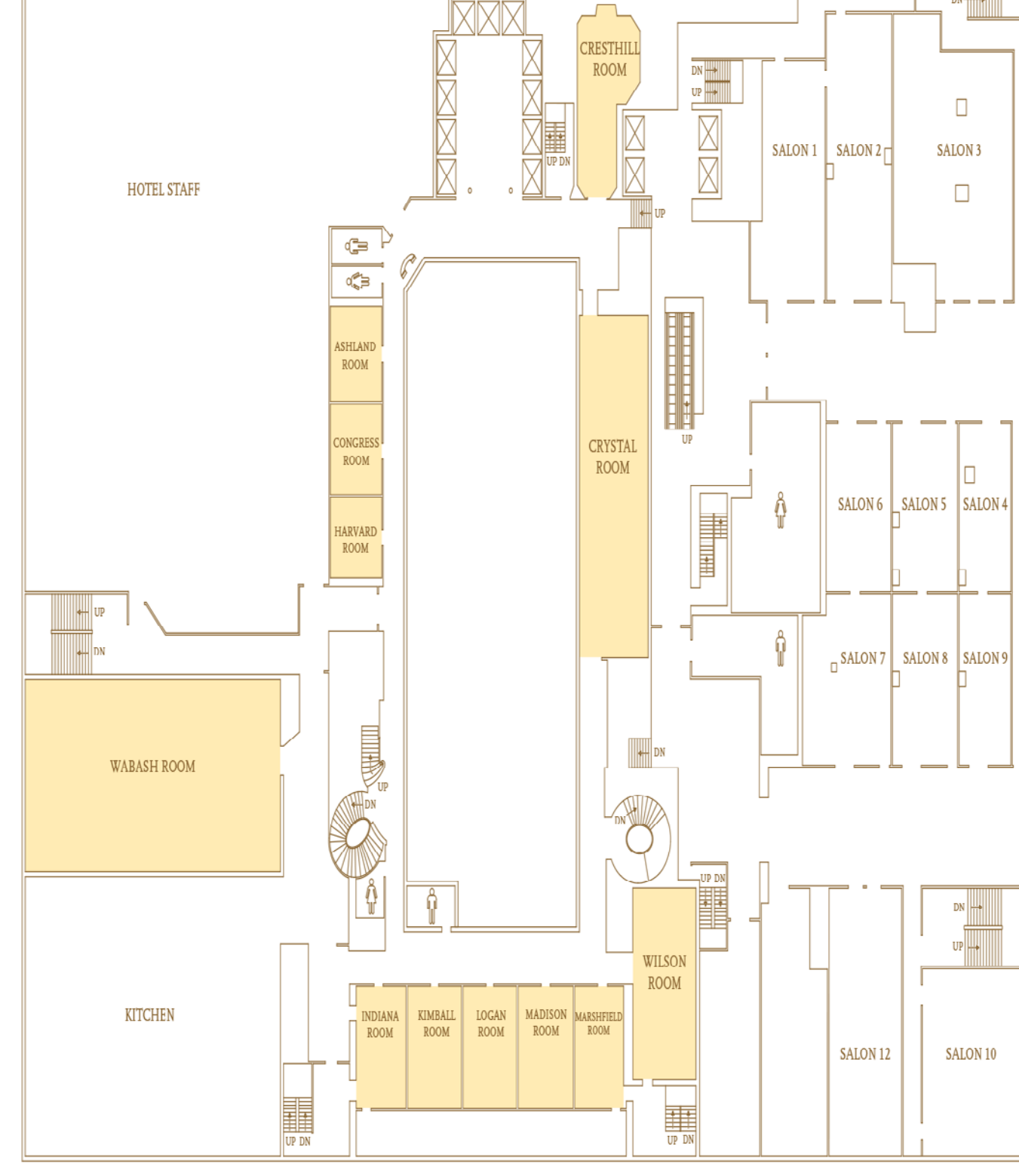

Program Agenda

For More Information

For more information, contact Gary Turner, EPA Office of Superfund Remediation and Technology Innovation, at (703) 603-9902 or by email at turner.gary@epa.gov.